



**JSF**  
TECHNOLOGIES  
ADVANCED TRAFFIC SOLUTIONS

www.JSFTech.com

sales@JSFTech.com

1-800-990-2454

## AB-7400-20W Pedestrian Activated Flashing Beacon

AB SERIES

### SELF-CONTAINED 20 WATT SOLAR ENGINE

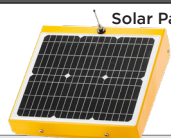

Solar Panel

Solar Cell - Monocrystalline Silicon  
Rated Power (Pmp) 20 Watts  
Rated Voltage (Vmp) 18 VDC  
Rated Current (Imp) 1.1 Amps  
CE and TUV certified

Solar Angle

44° (Standard)

Standard Battery Bank

AGM 12V, 18 Ah - UL Recognized,  
field replaceable

Cold Weather Battery Bank Option

AGM 12V, 16 Ah - UL Recognized,  
field replaceable

Solar Engine Housing Material

A5052 Sheet Aluminum (Enclosure)  
6061-T6 Aluminum (Mount)

Solar Engine Dimensions

15.75" x 13.25" X 4.5" (40 x 33.7 x 11.5cm)\*

### POWER MANAGEMENT

Rated Usage

300 cycles per day, 25 second activation

Charged Capacity

Up to 30 days at rated usage

Automatic Light Control (ALC)

Various stages of brightness for different  
solar conditions and battery levels

### SYSTEM PROTECTION

Low Voltage Disconnect

9.5 VDC

Over Current Protection

1.8 Amp PTC auto-reset fuse

Self Monitoring

Visual notification of sub-optimal operation

### LED BEACON SIGNAL HEAD

Standard Followed

ITE VTCSH-STD 2005

LED Beacon Signal Head Setup

Dual Heads,  
Vertical Pole Mounting

Lens Material

UV stabilized polycarbonate and  
Abrasion resistant

LED Housing

100% Polycarbonate

LED Size

8" Diameter (200 mm)\*  
12" Diameter (300mm)\*

LED Housing Dimensions

8" head - 14" x 10" x 6" (35 x 25 x 16 cm)\*  
12" head - 17" x 14" x 6" (44 x 25 x 17 cm)\*

Std. LED Color Options

Amber or Red (custom colors available)

### COMMUNICATION

Band of Operation

ISM Band (902-928 MHz)

Compliance

FCC and IC Compliant

Range

Up to 0.25 miles (400 m) with line of sight

Network Addresses

16 unique addresses to avoid interference  
between multiple crosswalk locations

Compatibility

Can communicate with other AB units

### SYSTEM OPTIONS

LED & Solar Engine Housing Colors

Yellow, Black or Green  
(custom colors available)

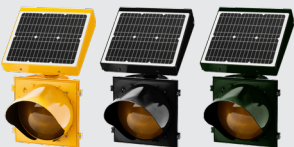

Mounting Options

Side Mount Bracket: 12", and 18"  
and custom lengths available  
Signal & Solar Head Side Mount Bracket  
Custom Mounts Available



7408-20W  
44° Standard Angle  
8" Amber LEDs

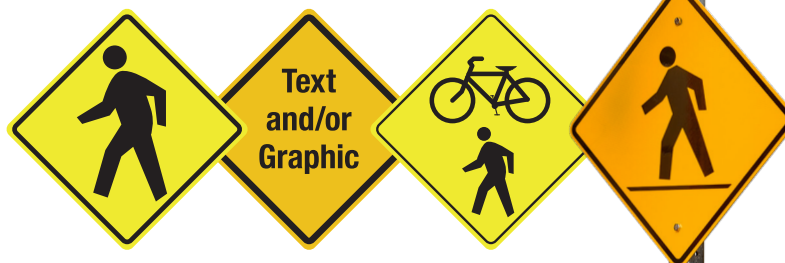

AVAILABLE WITH ANY STANDARD SIGN.  
CUSTOM SIGNS ARE AVAILABLE



AVAILABLE WITH RED LEDS FOR STOP  
SIGNS, AMBER LEDS FOR WARNING SIGNS

## SYSTEM OVERVIEW

Compliance	FHWA MUTCD Compliant
Standard Operation	Pedestrian Activated via push button or JSFT remote transmitters
Flash Pattern Options	MUTCD Standard (0.5 seconds ON, 0.5 seconds OFF) JSFT Strobe Energy Efficient Flash Pattern** MUTCD Wig - Wag JSFT Wig - Wag Strobe Energy Efficient Flash Pattern**
Activation Duration	Variable from 5 seconds to 4 hours
Std. Operating Temperature	14°F to +165°F (-10°C to +74°C)
Cold Weather Upgrade Option	-40°F to +176°F (-40°C to +80°C)
System Voltage	12 VDC
Packaged Dimensions	8" head - 36" x 18" x 18" @ 74 lbs (91.5 x 45.7 x 45.7cm @ 34 kg)* 12" head - 36" x 18" x 18" @ 80 lbs (91.5 x 45.7 x 45.7cm @ 36 kg)*

### SALES

Toll-Free 1.800.990.2454  
sales@jsftech.com

### SUPPORT

Toll-Free 1.800.990.2454  
support@jsftech.com

### ADDRESS

6582 Bryn Road,  
Victoria, BC V8M 1X6

**WARRANTY** 5-year Limited Warranty for defects in workmanship and materials (excludes batteries and vandalism)

*\*All measurements and weights are approximate \*\*50% power consumption of MUTCD*



**JSF**  
TECHNOLOGIES  
ADVANCED TRAFFIC SOLUTIONS

www.JSFTech.com

sales@JSFTech.com

1-800-990-2454

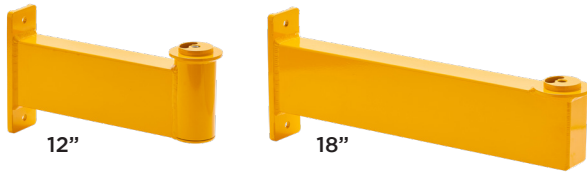

12"

18"

SIDE MOUNTBRACKET

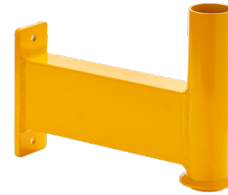

SIGNAL HEAD & SOLAR ENGINE  
SIDE MOUNT BRACKET

## SIGNAL HEAD MOUNTING OPTIONS SOLAR ENGINE MOUNTING OPTIONS

ISO VIEW

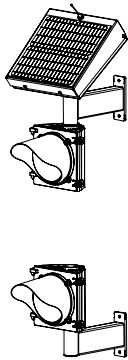

AB-7408-20W

FRONT VIEW

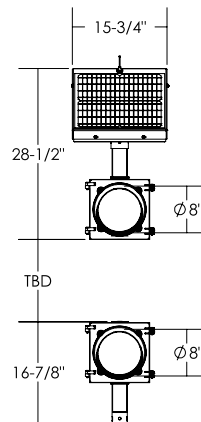

SIDE VIEW

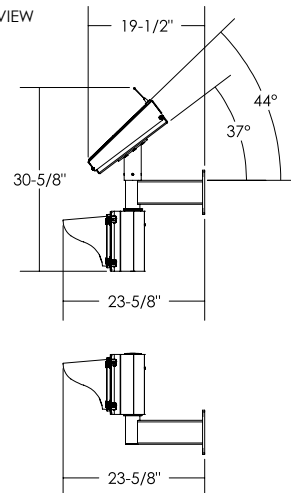

ISO VIEW

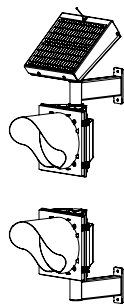

AB-7412-20W

FRONT VIEW

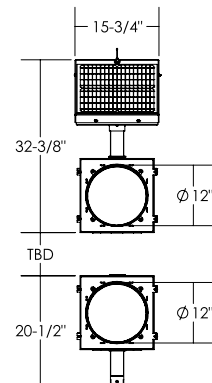

SIDE VIEW

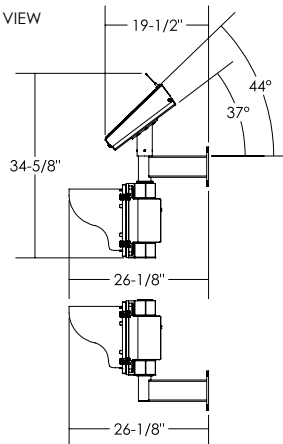

## SYSTEM DRAWINGS

Copyright © 2020 JSF Technologies. All Rights Reserved.

Specification and information contained in this data sheet are furnished for informational use only, and are subject to change at any time without notice.